

MD012012

Gearbox Specifications

Outer diameter	12mm	Bearing	Porous bearing
Material	Metal	Axial endplay	≤0.3mm
Direction of rotation	cw & ccw	Radial loading on output shaft	≤10N
Gear backlash	≤3°	Operating temperature range	-20 ~ +85°C

Gearbox Stages

	1	2	3	4
Reduction ratio	4 / 6	16 / 24 / 36	64 / 96 / 144 / 216	256 / 384 / 576 / 864 / 1296
Max rated torque of gearbox (gf.cm)	300	1000	1500	2000
Instant torque of gearbox (gf.cm)	1000	3000	4500	5000
Gearbox efficiency (%)	87	74	63	56
Gearbox length L1 (mm)	12.4	16.2	20	23.8

Technical Drawing

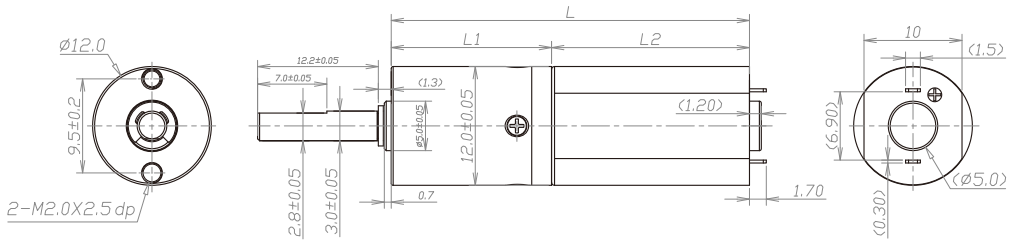

Motor Specifications

Motor type (optional)	Brushed DC motor, Brushless DC motor, Coreless motor, Stepper motor	Input speed	≤30000rpm
Voltage (optional)	3-24V	Current	250mA max

Model	Rated Speed	Max Speed	Max Rated Torque	Max Instant Torque	Reduction Ratio	Gearbox Length	Overall Length
	rpm	rpm	gf.cm	gf.cm		mm	mm
MD012012-4	1875	7500	300	1000	4	12.4	32.4
MD012012-6	1250	5000	300	1000	6		
MD012012-16	469	1875	1000	3000	16	16.2	36.2
MD012012-24	313	1250	1000	3000	24		
MD012012-36	208	833	1000	3000	36		
MD012012-64	117	469	1500	4500	64	20	40
MD012012-96	78	313	1500	4500	96		
MD012012-144	52	208	1500	4500	144		
MD012012-216	35	139	1500	4500	216		
MD012012-256	29	117	2000	5000	256	23.8	43.8
MD012012-384	20	78	2000	5000	384		
MD012012-576	13	52	2000	5000	576		
MD012012-864	9	35	2000	5000	864		
MD012012-1296	6	23	2000	5000	1296		

*Please contact us for customized products